

1

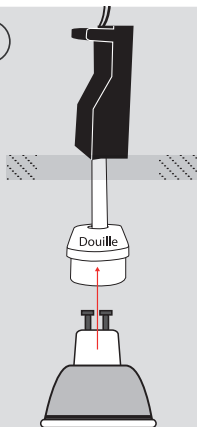

**Percer le plafond.
Drill the ceiling.
Perforar el techo.**

2



**Clipser l'ampoule à la douille.
Clip the bulb at the socket.
Sujeta la bombilla en el zócalo.**

3

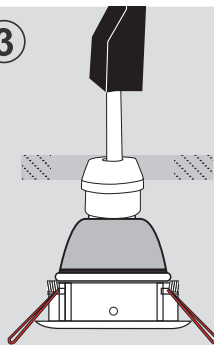

Positionner l'ampoule au dessus du support entre les ailettes de positionnement.

Position the bulb above the support between positioning fins.

Posicionar la bombilla por encima del soporte entre aletas de posicionamiento.

4

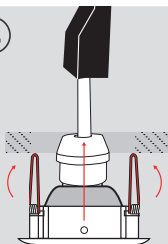

**Rabattre les ailettes sur ressorts.
Place the bulb, the socket and the spot support in the drilling diameter of the ceiling.
Fold the wings on springs.
Place the bulb, the socket and spot support in the drilling diameter ceiling.
Dobla las alas en manantiales.
Coloque la bombilla, el zócalo y apoyo al contado en el diámetro de perforación techo.**

5

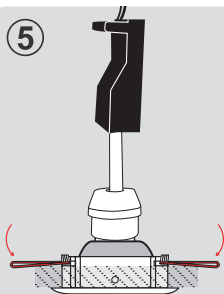

**Rabattre les ailettes au dessus du plafond.
Fold the wings above the ceiling.
Dobla las alas por encima del techo.**

6

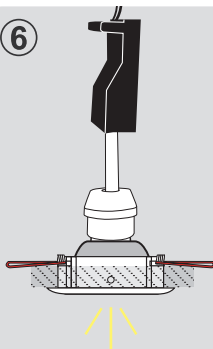

7

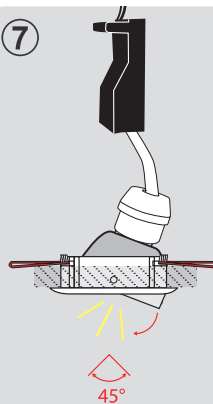

**Spot inclinable
Reclining spot
Lugar de descanso**

1



**Praticare il soffitto.
Bohren Sie die Decke.**

2

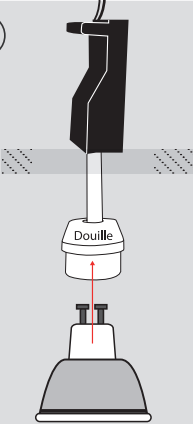

**Aggancia la lampadina alla presa.
Clip die Birne an die Steckdose.**

3



**Posiziona la lampadina sopra il supporto tra le alette di posizionamento.
Positionieren Sie die Glühbirne über der Unterstützung zwischen die Positionierungsflossen.**

4



**Piega le ali sulle molle. Posiziona la lampadina, la presa e supporto spot nel diametro della perforazione il soffitto.
Falten Sie die Flügel auf Federn. Platzieren Sie die Glühbirne, die Steckdose und punktuelle Unterstützung im Bohrdurchmesser der Decke.**

5



**Piega le ali sopra il soffitto.
Falten Sie die Flügel über der Decke.**

6

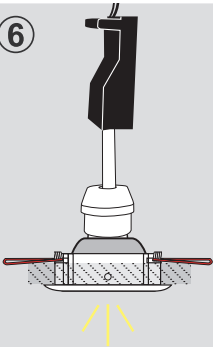

7

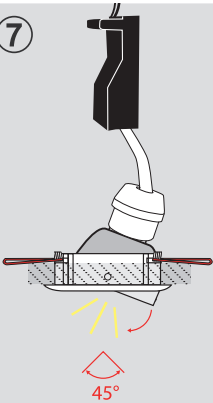

**Spot inclinabile
Liegender Fleck**